

Steel wall-mounting enclosures

Accessories

Handles

PB500343-19



PB500364-6



Characteristics	Standard handle	Handle lock operated using screwdriver insert
	<p>Operating handle delivered with the enclosure.</p> <ul style="list-style-type: none"> ■ It can be attached to the locking system by means of a fixing element. ■ It can also be used to loosen the caps protecting the studs when painting. 	-
References	NSYAEDLS3DKDB3	NSYTSMLS3D

PB500346-14



PB500347-35

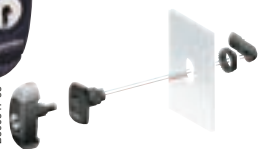

Characteristics	Standard handles with keys
	<p>Attractive and ergonomic bi-material handle.</p> <ul style="list-style-type: none"> ■ Large range of barrels covering all the most common needs. ■ The installation of the standard handle does not require the escutcheon to be removed. ■ Locks may only be operated using the supplied keys.
Composition	Delivered with 2 keys
References	
405	NSYAEDL405S3D
421	NSYAEDL421S3D
455	NSYAEDL455S3D
520	NSYAEDL520S3D
601	NSYAEDL601S3D
610E	NSYAEDL610S3D
705E	NSYAEDL705S3D
1242	NSYAEDL1242S3D
1332E	NSYAEDL1332S3D
1344E	NSYAEDL1344S3D
2124E	NSYAEDL2124S3D
2131A	NSYAEDL2131S3D
2132A	NSYAEDL2132S3D
2133A	NSYAEDL2133S3D
2241A	NSYAEDL2241S3D
2244E	NSYAEDL2244S3D
2314E	NSYAEDL2314S3D
2322A	NSYAEDL2322S3D
2331A	NSYAEDL2331S3D
2432E	NSYAEDL2432S3D
2433A	NSYAEDL2433S3D
3113A	NSYAEDL3113S3D
3123E	NSYAEDL3123S3D
3131A	NSYAEDL3131AS3D
3132A	NSYAEDL3132S3D
3432E	NSYAEDL3432S3D
3524E	NSYAEDL3524S3D
4322A	NSYAEDL4322S3D
4324E	NSYAEDL4324S3D
5124A	NSYAEDL5124S3D

Steel wall-mounting enclosures

Accessories

Locks

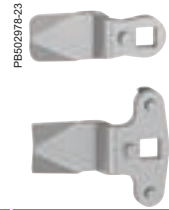
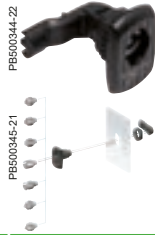

Characteristics	Standard locks	Barrel DIN kit	Double bar 3 mm metal lock	Metal cam kit 1 point and 3 points
	Spacial S3D wall-mounting enclosures are supplied with a 3 mm double-bar lock as standard. <ul style="list-style-type: none"> ■ Spare lock: order ref. NSYAEDLS3DRL (escutcheon + cam + washer). ■ Large range of standardised inserts covering all the most common needs. ■ Installation and removal with a single screw. 	<ul style="list-style-type: none"> ■ Mounting of half-cylinder according to DIN 18252 (EN1303). Cam can be turned every 45°. ■ Easy mounting instead of standard lock. ■ Compatible with PLM barrels offer. See page 174. (Example: NSYTL1242EME). 	Easy mounting instead of standard lock.	To adapt other locks.
Material	Zamack + polyamide	Polyamide GF	Zamak	Zinc-coated metal
Ingress protection rating	IP66 according to IEC 60529	IP66 according to IEC 60529	IP66 according to IEC 60529	-
Supply	Delivered with 1 plastic key	Delivered with metal cam 1 point and metal cam 3 points	Delivered with metal cam 1 point and metal cam 3 points	-
References				
-	-	NSYAEDDINS3D	NSYAEDLB3MS3D	NSYAEDLMETS3D
6 mm square	NSYAEDLS6S3D			
7 mm square	NSYAEDLS7S3D			
8 mm square	NSYAEDLS8S3D			
3 mm double bar	NSYAEDLB3S3D			
5 mm double bar	NSYAEDLB5S3D			
CNOMO 6.5 mm triangular	NSYAEDLT6S3D			
8 mm triangular	NSYAEDLT8S3D			

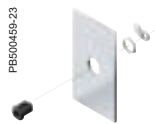

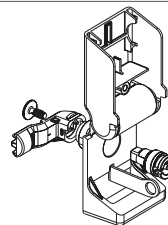
Characteristics	Lock with screwdriver insert and metal latch	Padlock	Other locks with keys
	-	Easy mounting instead of the standard lock.	Easy mounting instead of the standard lock.
Material	Zamak	Zamak	Aluminium
Ingress protection rating	IP55 (IEC 60529)	IP66 (IEC 60529)	IP66 (IEC 60529)
Supply	Delivered with housing, insert, fixing nut and metal cam 3 points	Delivered with metal key	Delivered with metal cam 1 point and metal cam 3 points
References			
	NSYAEDLSDS3D	Padlockable (1) NSYAEDLPADS3D	EDF 900 NSYAEDLEDF9S3D EDF 1300 NSYAEDLEDF13S3D EDF 1400 NSYAEDLEDF14S3D
			

(1) Diameter 8 mm.



Characteristics	"Push-close" locking system
	The Spacial S3D enclosures can be transformed into push-close enclosures. <ul style="list-style-type: none"> ■ The push-close enclosure is used in various applications and fully meets the security demands of the market. ■ Locking system with a 6.5-mm push-close system in accordance with CNOMO standards. ■ This system allows the door to be closed and locked by simply pushing it. ■ System made up of a lock and a closure plate. ■ It is only installed on enclosures with 1 locking point (H < 600 mm). ■ Other dimensions: contact us.
Ingress protection rating	IP55 according to IEC 60529
References	
-	NSYAEDLPSS3D